

Text:		ID number:	1379196-00
Original drawing		Change No.:	C141061-06
Scale		Released:	27-Sep-22
Format		Tolerances as per ISO 8015 : 2011 Tolérances selon ISO 8015 : 2011	
Dimensions in mm	1:1 A1	Dimensions without tolerance Dimensions sans tolérances ± 0.2	
The reproduction, distribution and utilization of this document as well as the communication of its contents to others without express authorization is prohibited. Offenders will be held liable for the payment of damages. All rights reserved in the event of the grant of a patent, utility model or design. (ISO 18015)			
ETEL ETEL S.A. 2112 Möllers SWITZERLAND		Version Revision Sheet Page	1381627-00 - A-01 Document number 1 of 1

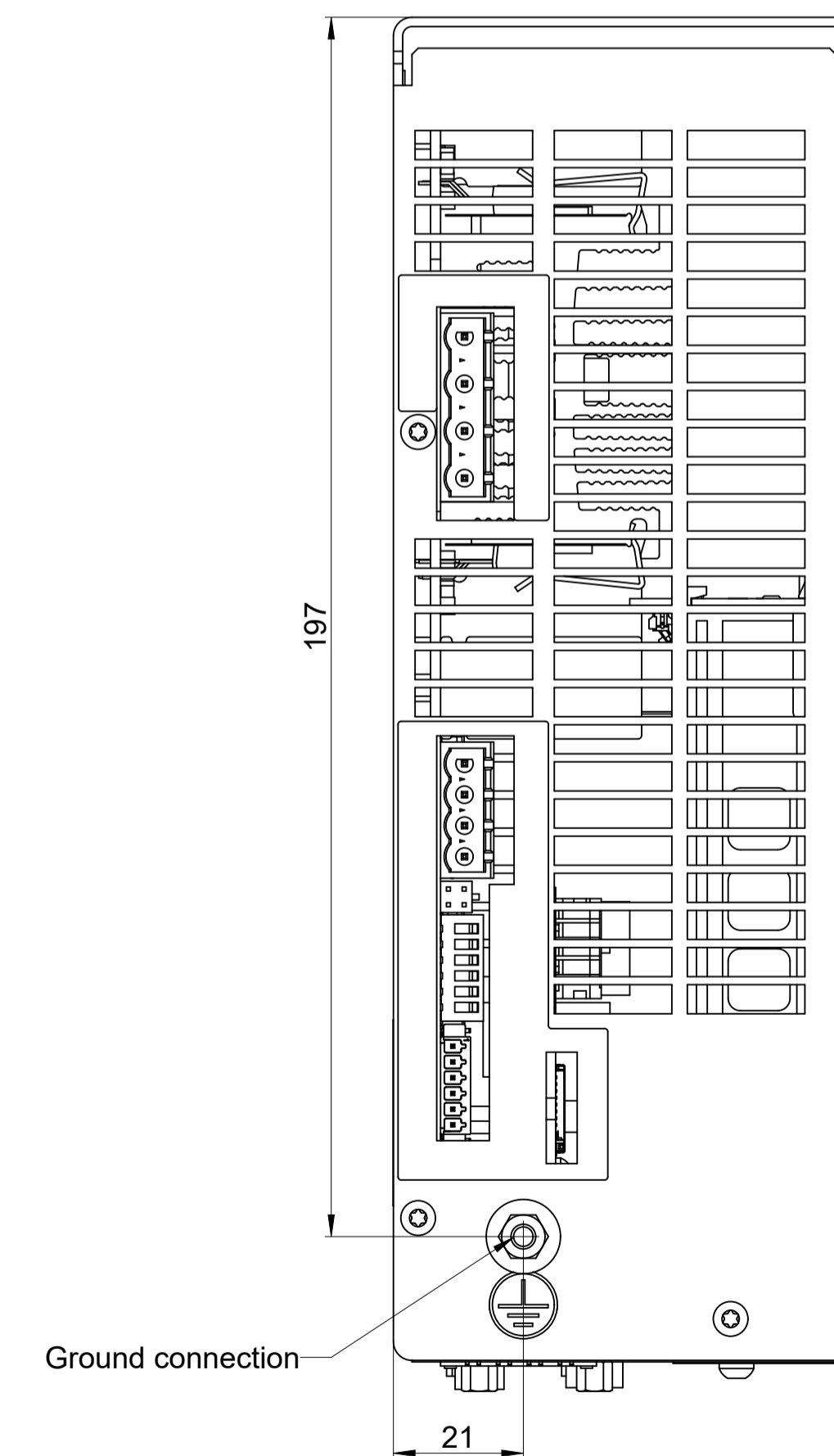

Text:		ID number:	1379197-00
Original drawing		Change No.:	C141061-06
Scale		Released:	27-Sep-22
Format		Tolerances as per ISO 8015 : 2011 Tolérances selon ISO 8015 : 2011	
Dimensions in mm	1:1 A1	Dimensions without tolerance Dimensions sans tolérances ± 0.2	
EA+P2M-300 AccurET+ 300 op Box		Mating Dimensions / Cotes d'encastrement	
The reproduction, distribution and utilization of this document as well as the communication of its contents to others without express authorization is prohibited. Offenders will be held liable for the payment of damages. All rights reserved in the event of the grant of a patent, utility model or design. (ISO 18015)			
ETEL ETEL S.A. 2112 Möllers SWITZERLAND		Version Revision Sheet Page	1381614-00 - A-01 Document number 1 of 1

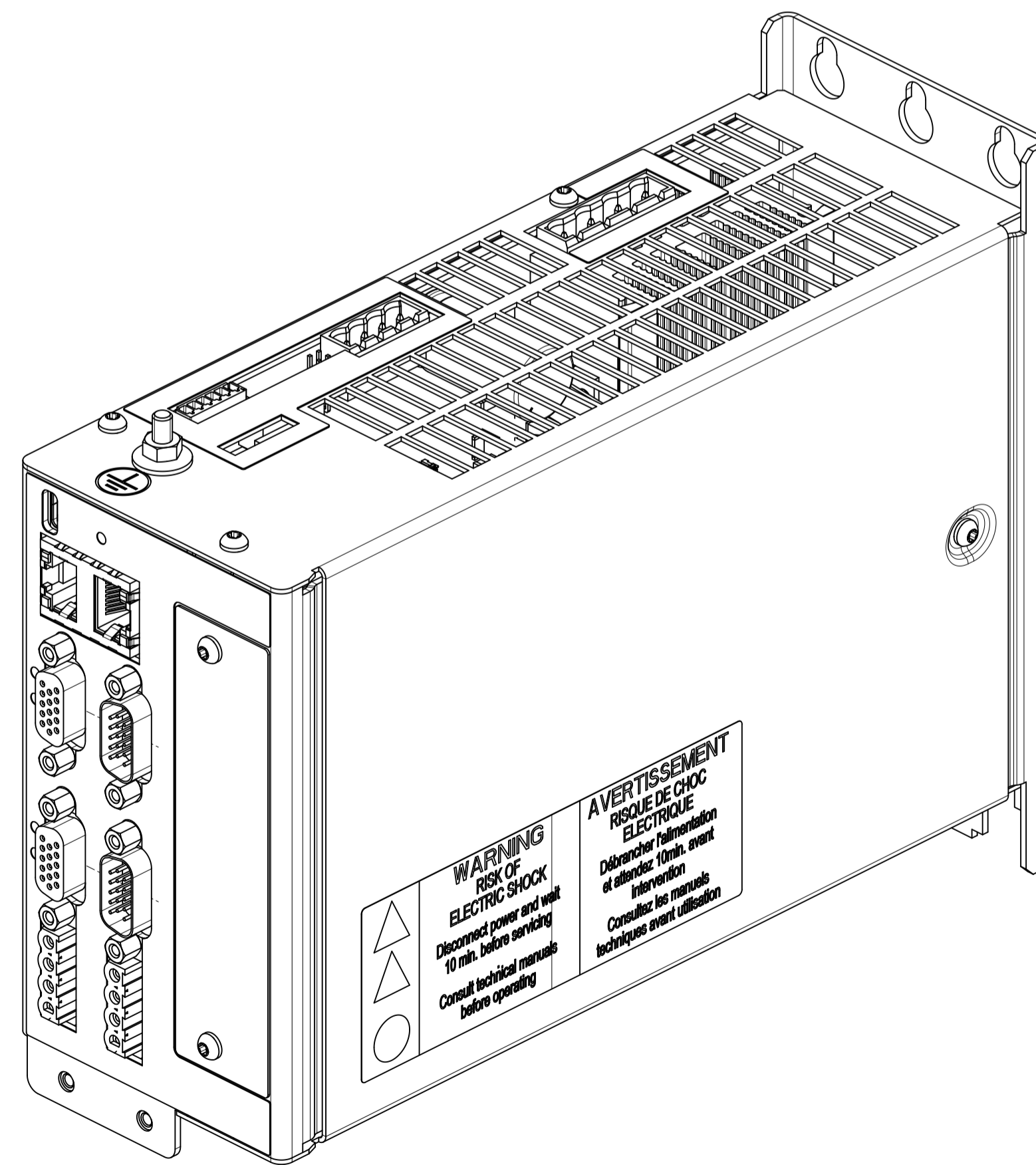
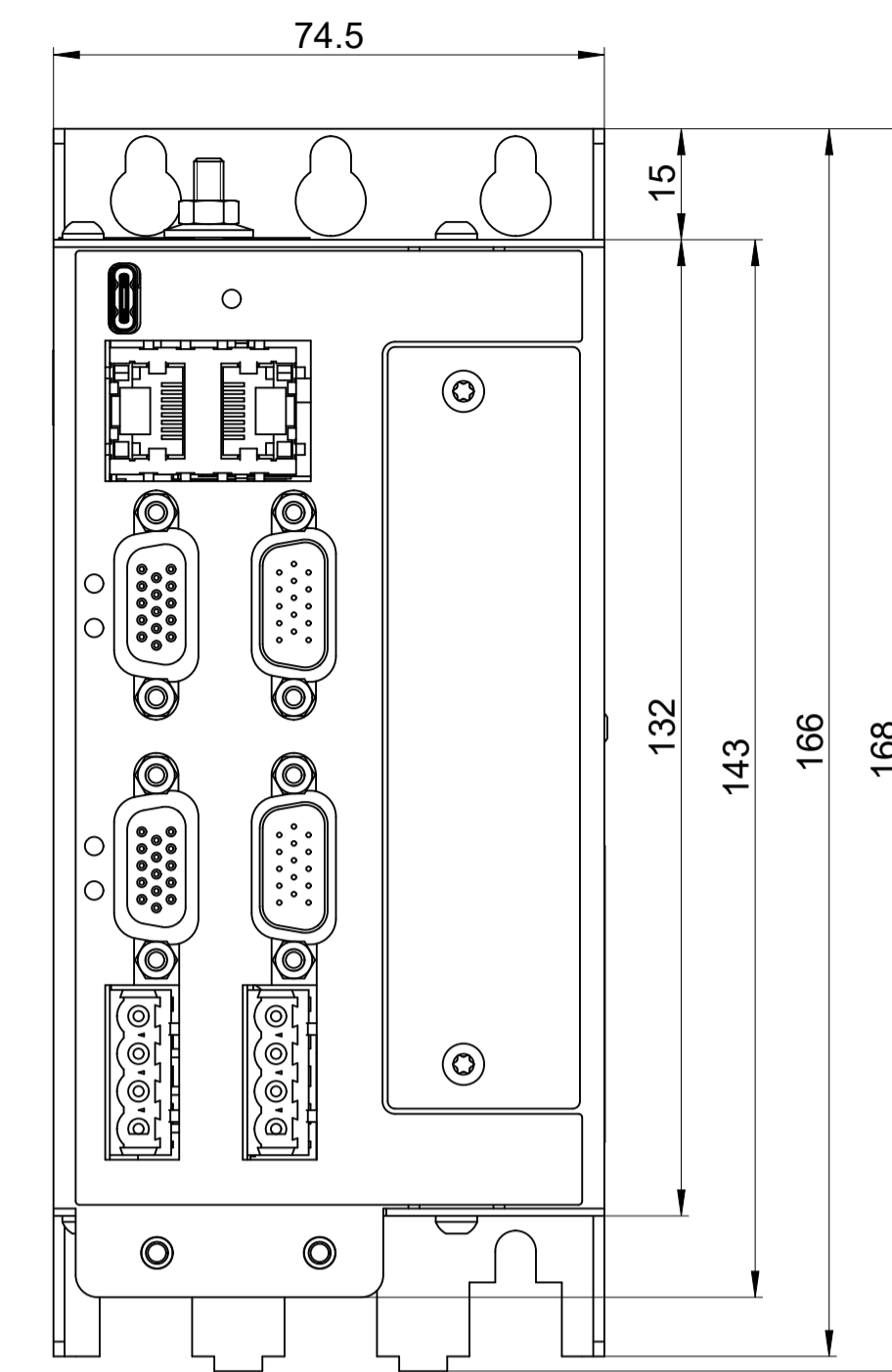
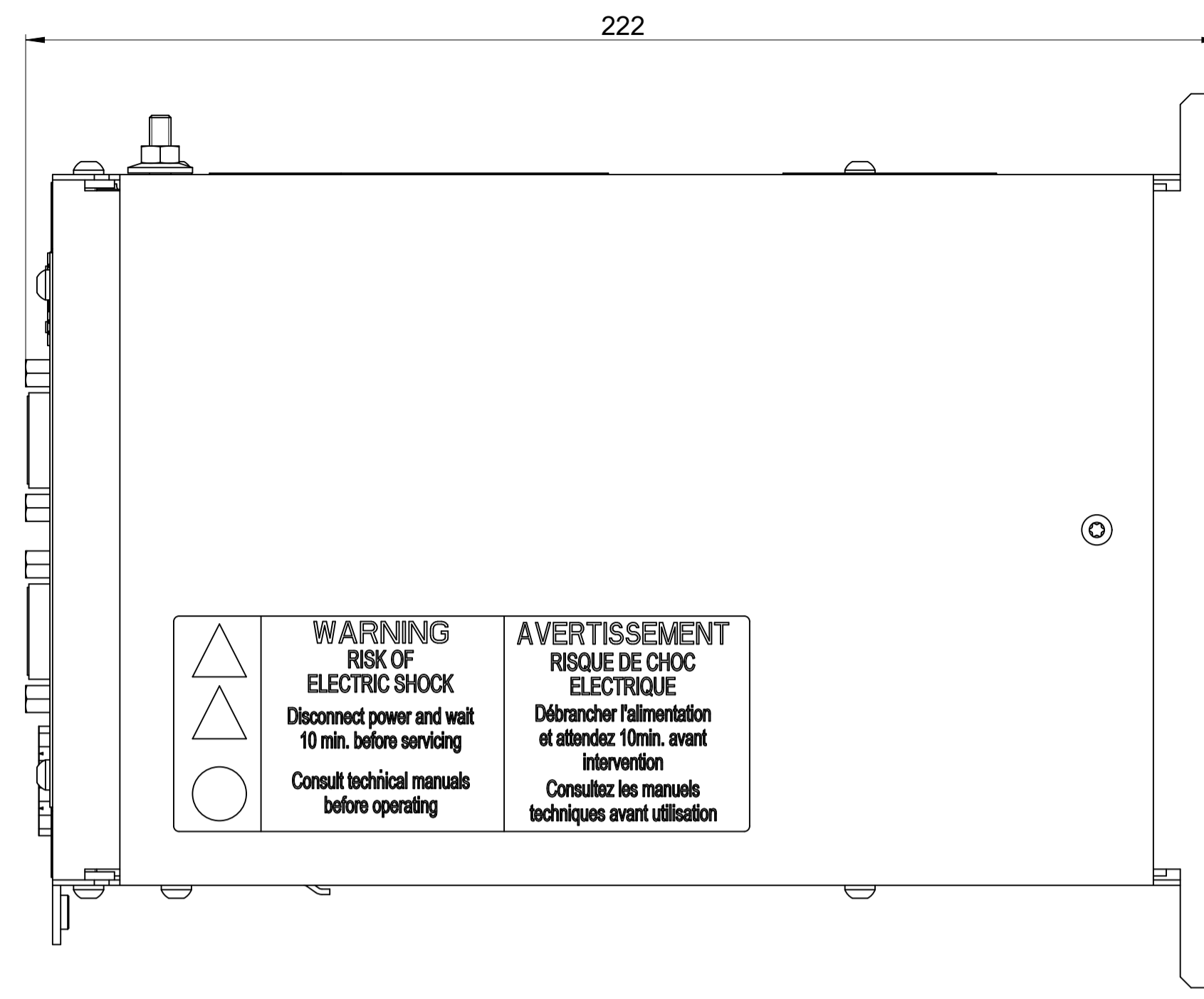
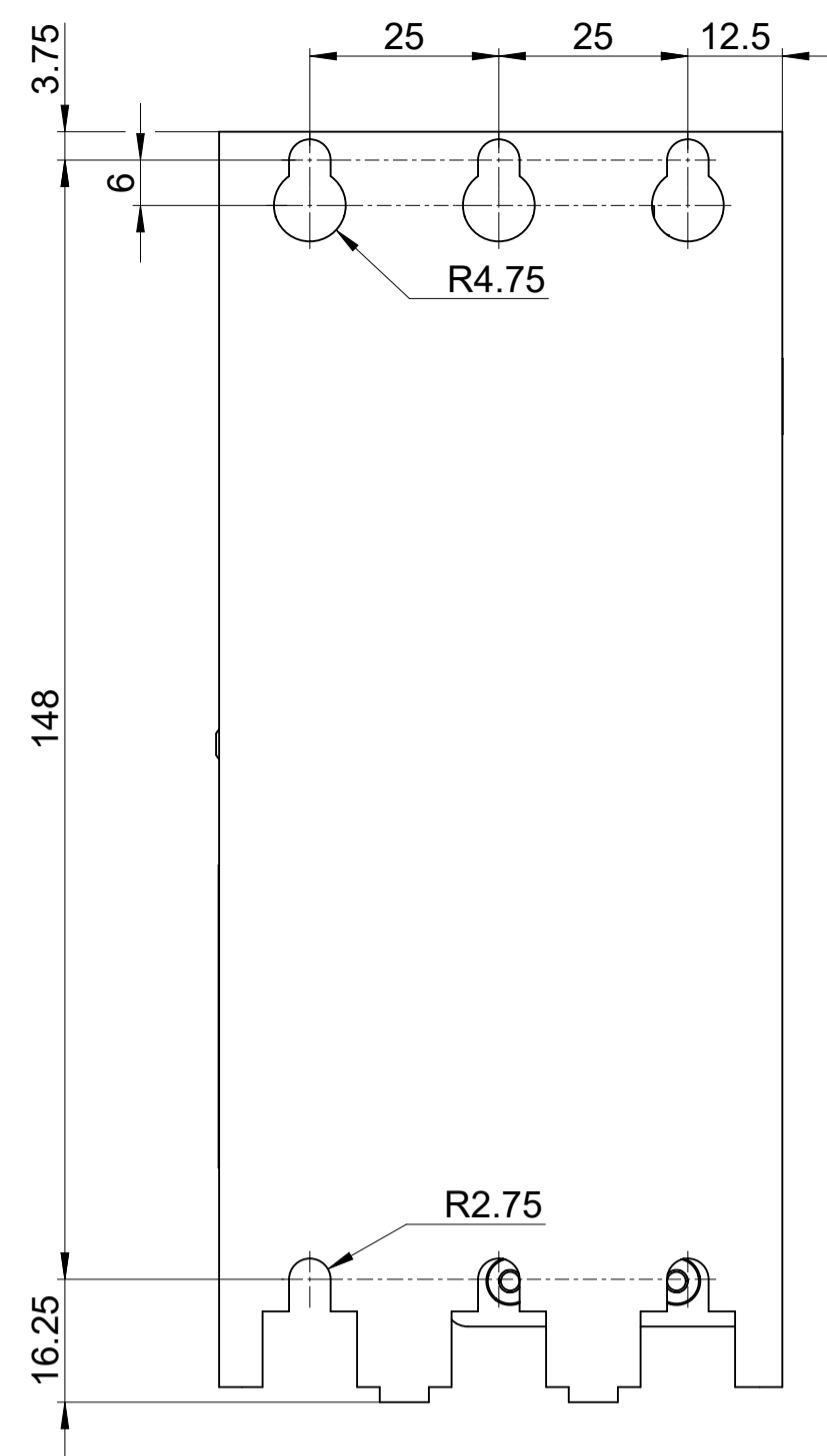
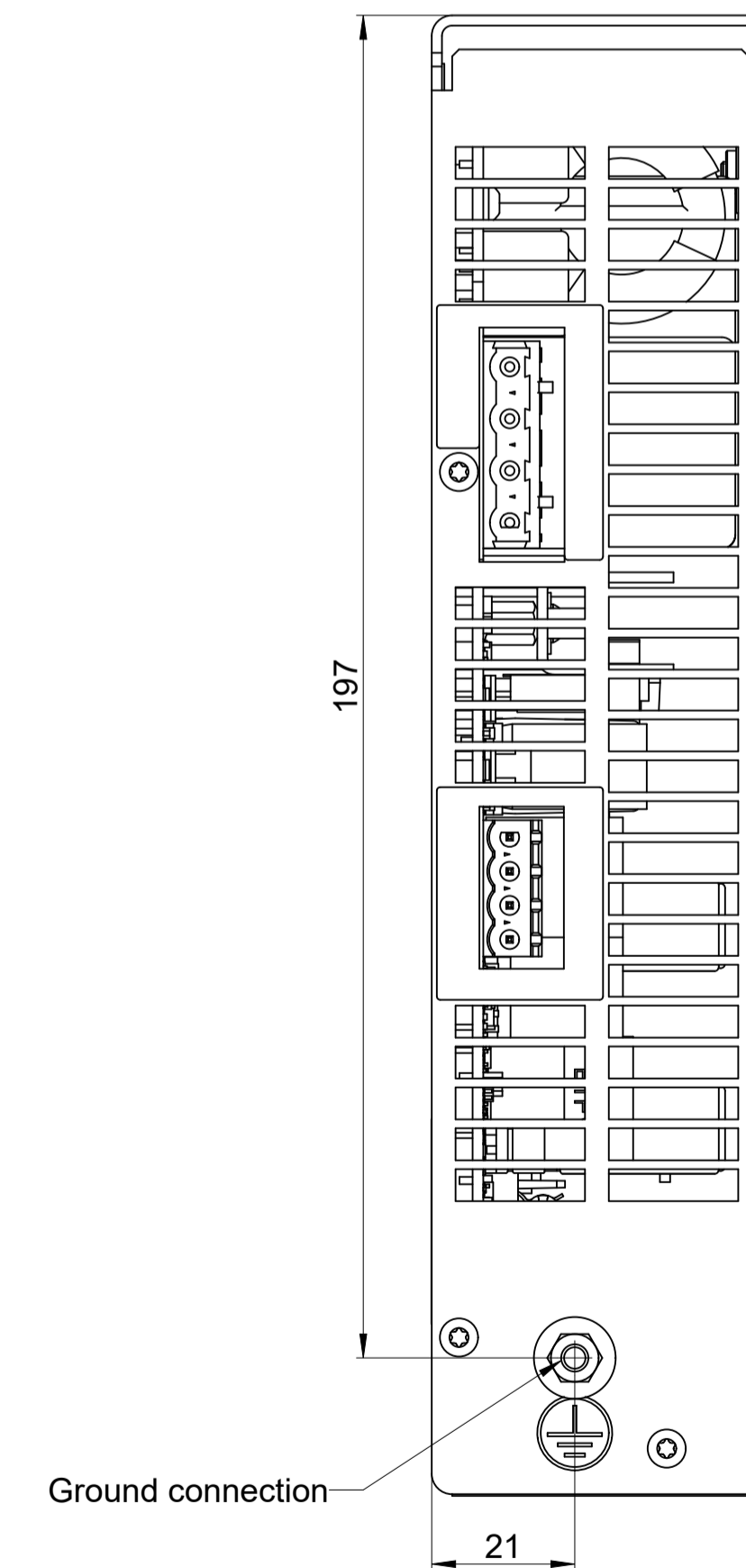
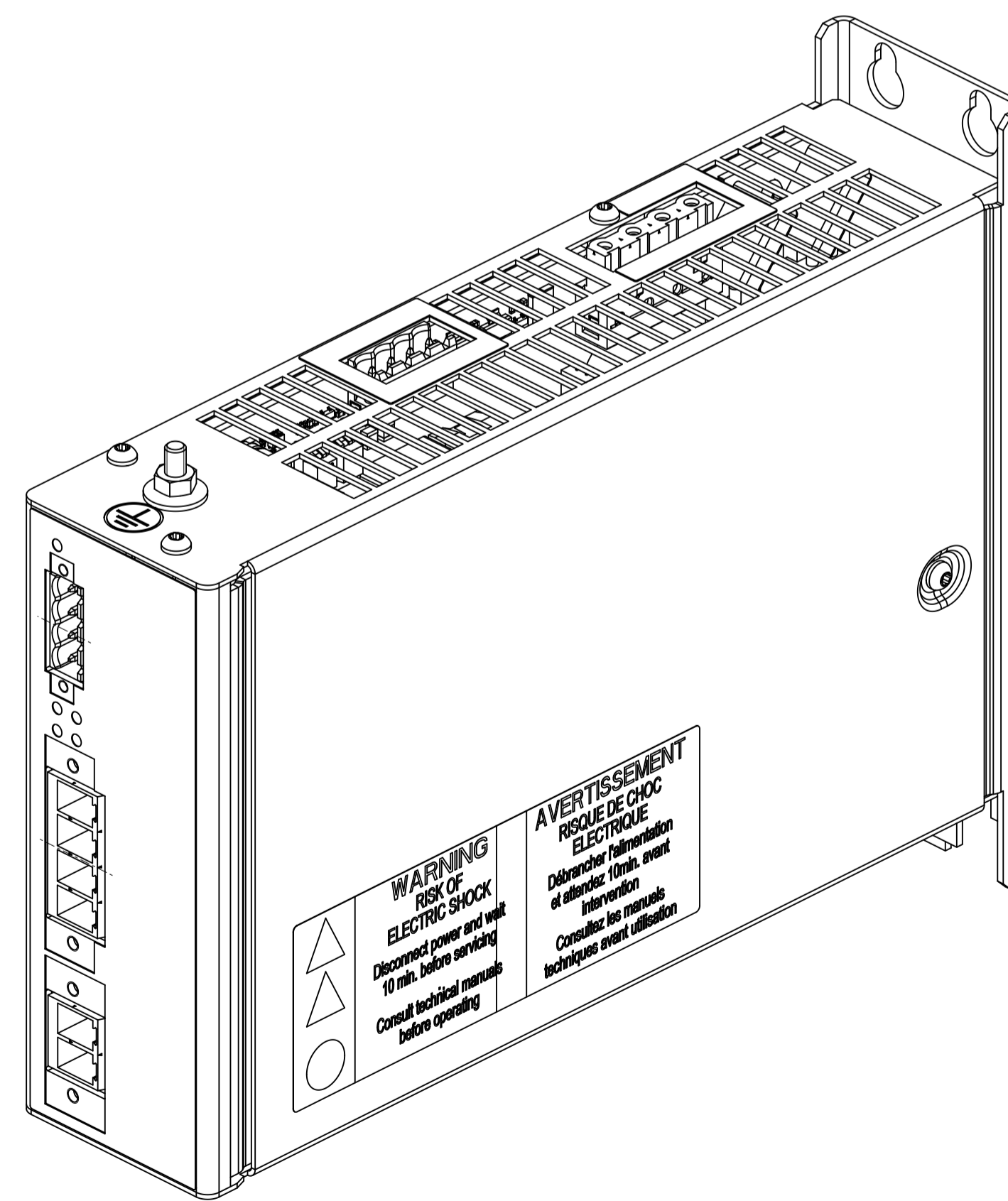
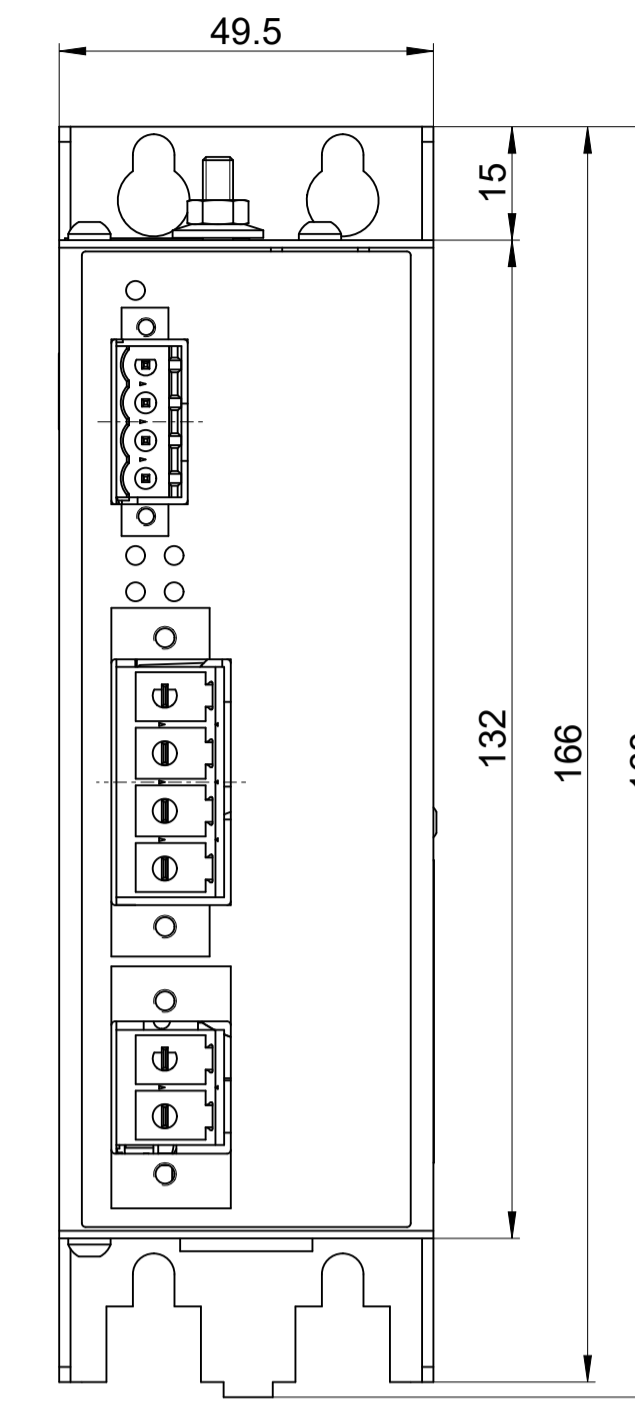
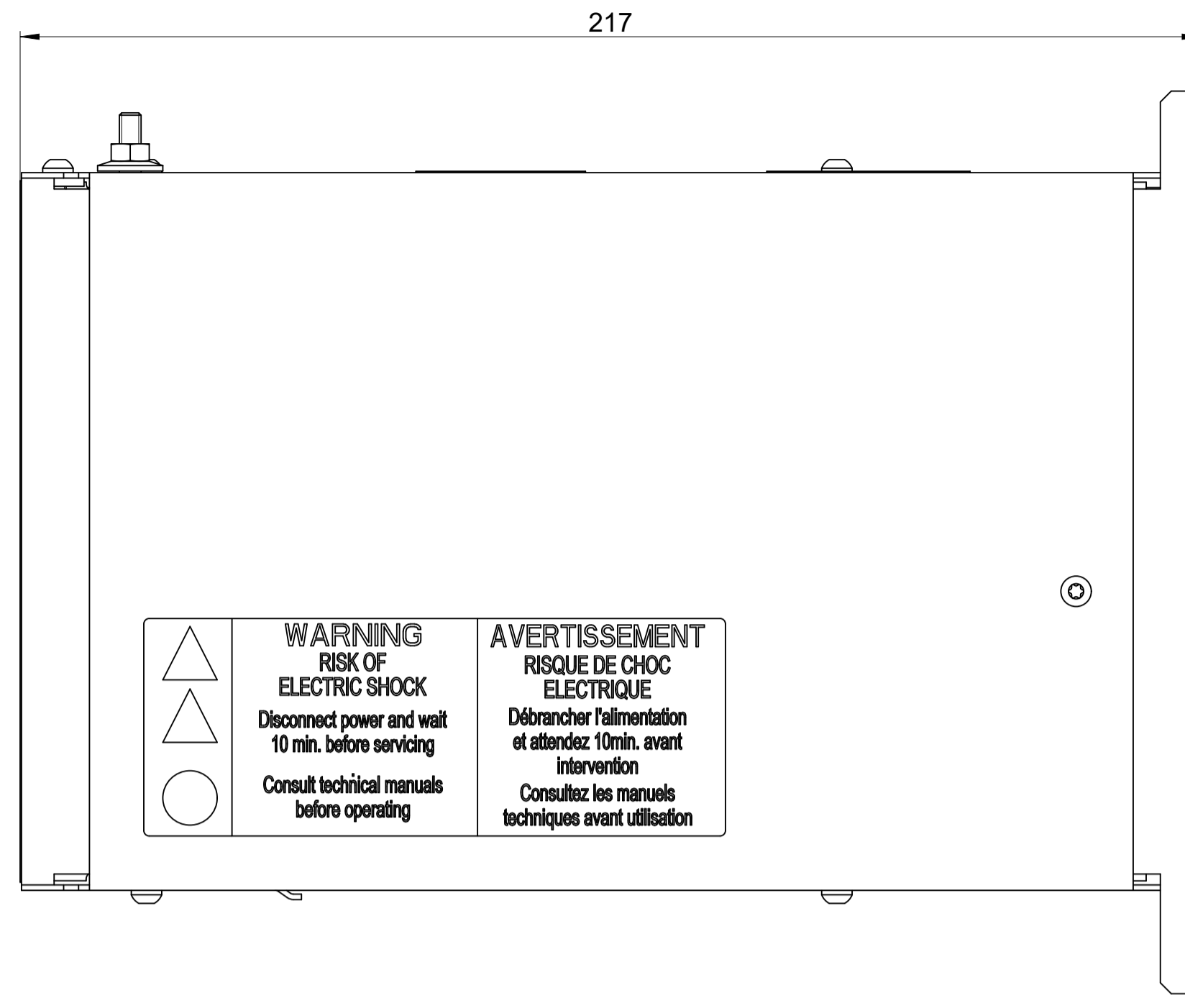
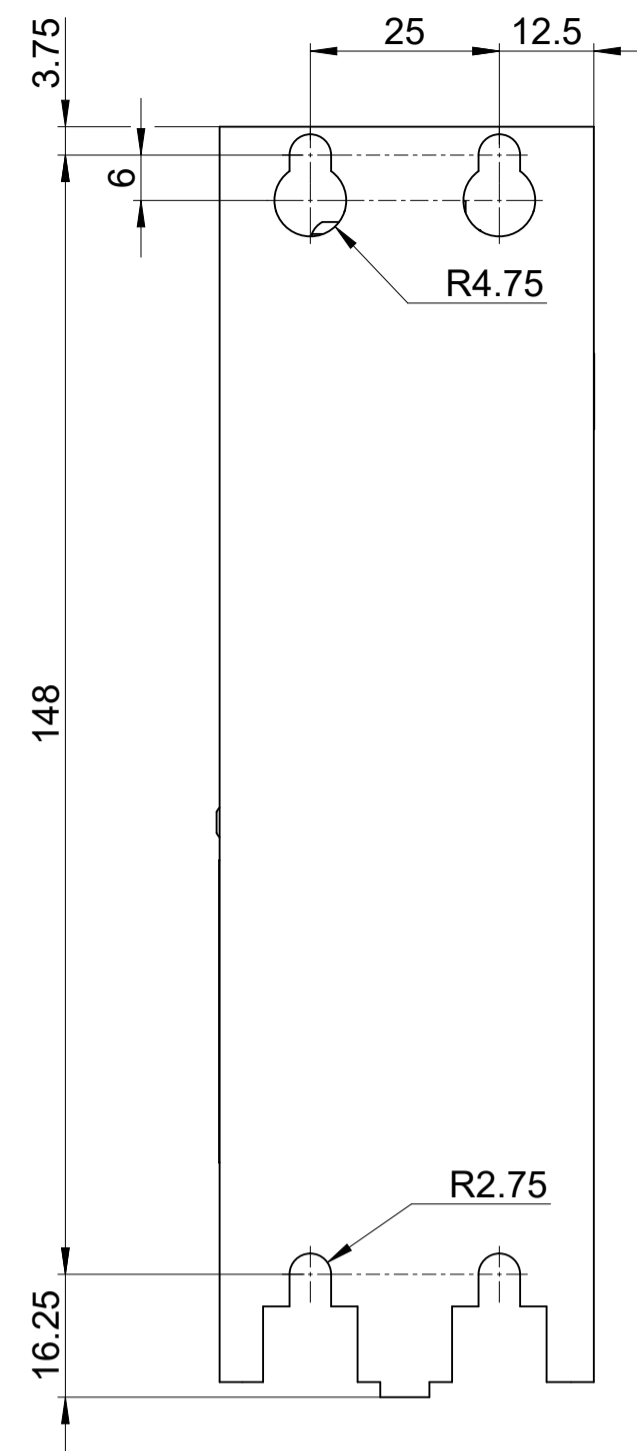

Text:		ID number: 1377053-01
Change No. C141061-21		Released: 27-Sep-22
Tolerances as per ISO 8015 : 2011 Tolérances selon ISO 8015 : 2011		Dimensions without tolerance Dimensions sans tolérances ± 0.2
The reproduction, distribution and utilization of this document as well as the communication of its contents to others without express authorization is prohibited. Offenders will be held liable for the payment of damages. All rights reserved in the event of the grant of a patent, utility model or design. (ISO 18015)		Version Revision Sheet Page
ETEL S.A. 2112 Möllers SWITZERLAND		1381647-00-A-01 Document number 1 of 1